

PLATE 01 · 1 BEDROOM · 2.2 M CEILING

Single bedroom open-plan studio.

Single bedroom layout – maximises open-plan living space. Ideal for couples, weekenders, or rental studios.

INCLUDED

- Queen master bedroom with corner windows
- Oversized open-plan kitchen + living zone
- Full bathroom – shower, toilet, vanity
- Full-height sliding doors to living zone

DIMENSIONS

5,900 mm **6,300 mm** **37.2 m²**
LENGTH WIDTH FLOOR AREA

1 **2** **2.2 m**
BEDROOMS SLEEPS CEILING

FROM

\$35,900

AUD · incl. GST

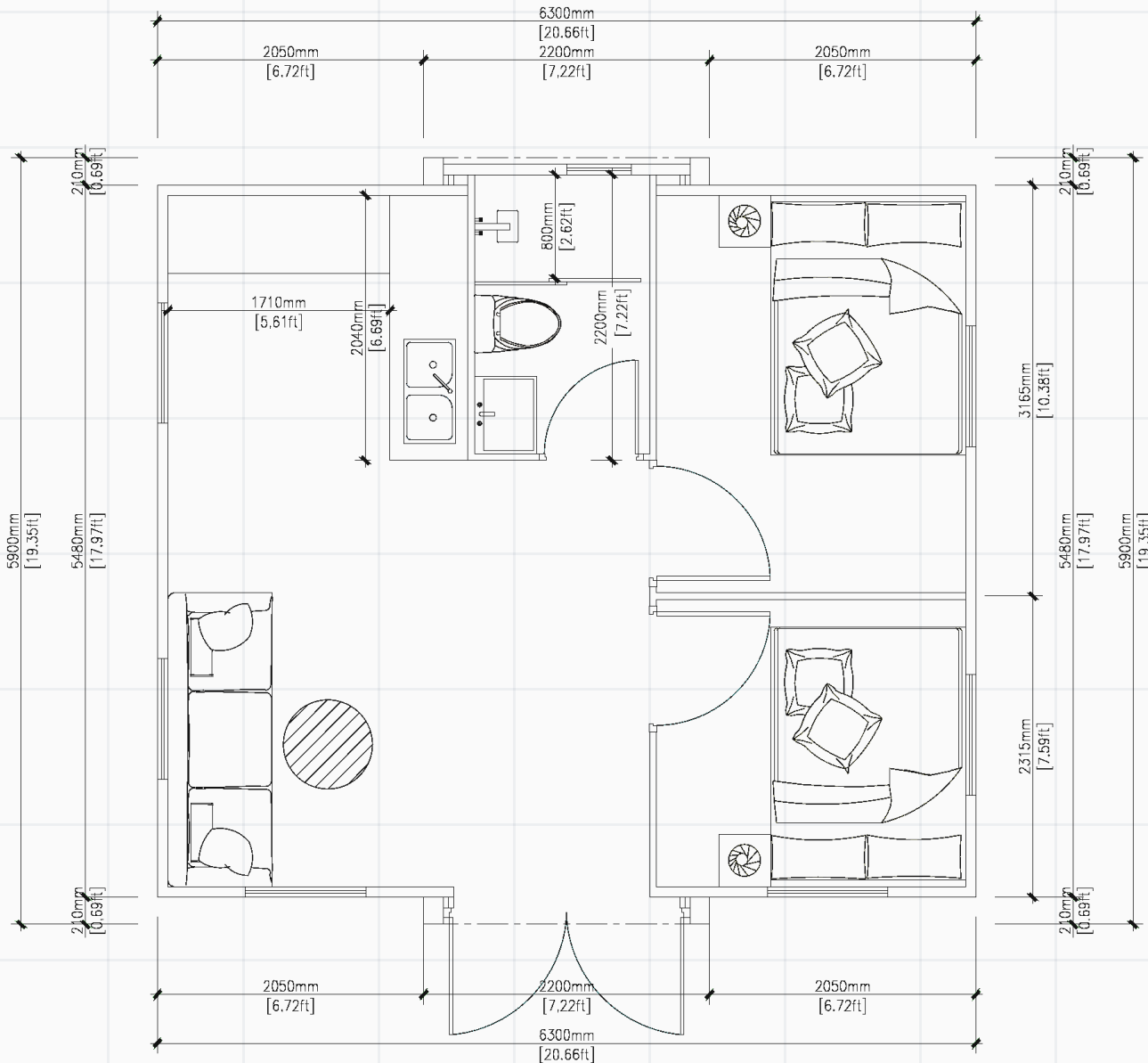

PLATE 02 · 2 BEDROOMS · 2.2M CEILING

Master + kids room / study.

Master plus a kids room / study with shared bathroom – great for small families, granny flats or short-stay setups.

INCLUDED

- Queen master with corner glazing
- Second room configured as kids room / study
- Shared central bathroom between both rooms
- Open-plan kitchen and living to the west

DIMENSIONS

5,900 mm **6,300 mm** **37.2 m²**
LENGTH WIDTH FLOOR AREA

2 **3** **2.2 m**
BEDROOMS SLEEPS CEILING

FROM

\$36,900

AUD · incl. GST

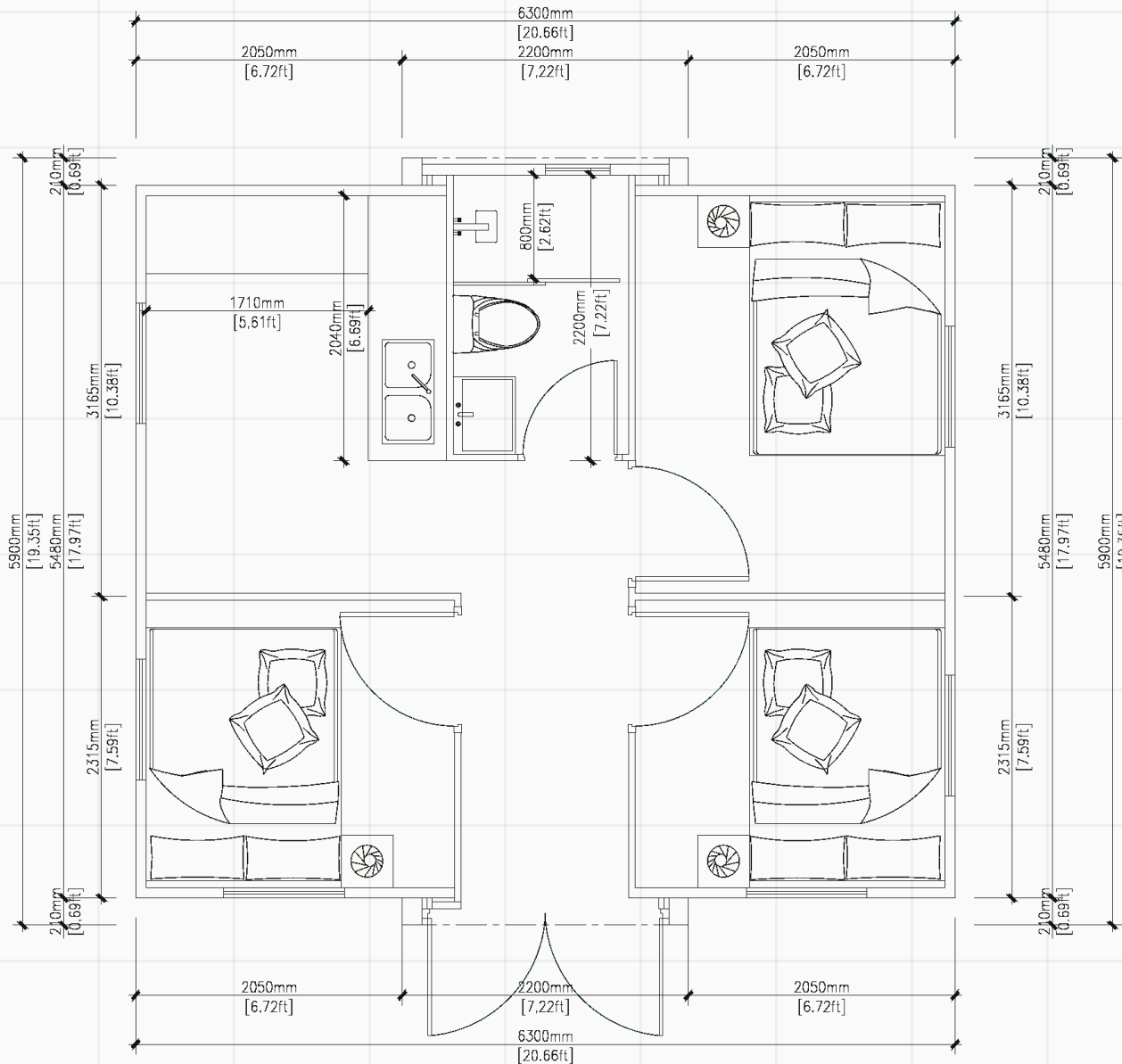

PLATE 03 · 3 BEDROOMS · 2.2M CEILING

Three-bedroom family footprint.

Three bedrooms — a full family footprint in just 20ft. Flexible zones for kids, guests or a home office.

INCLUDED

- Queen master to the east wing
- Two kids rooms / studies off the central hall
- Compact kitchen + bathroom core
- Corridor entry with wardrobes to each bedroom

DIMENSIONS

5,900 mm **6,300 mm** **37.2 m²**
LENGTH WIDTH FLOOR AREA

3 **4** **2.2 m**
BEDROOMS SLEEPS CEILING

FROM

\$38,900

AUD · incl. GST

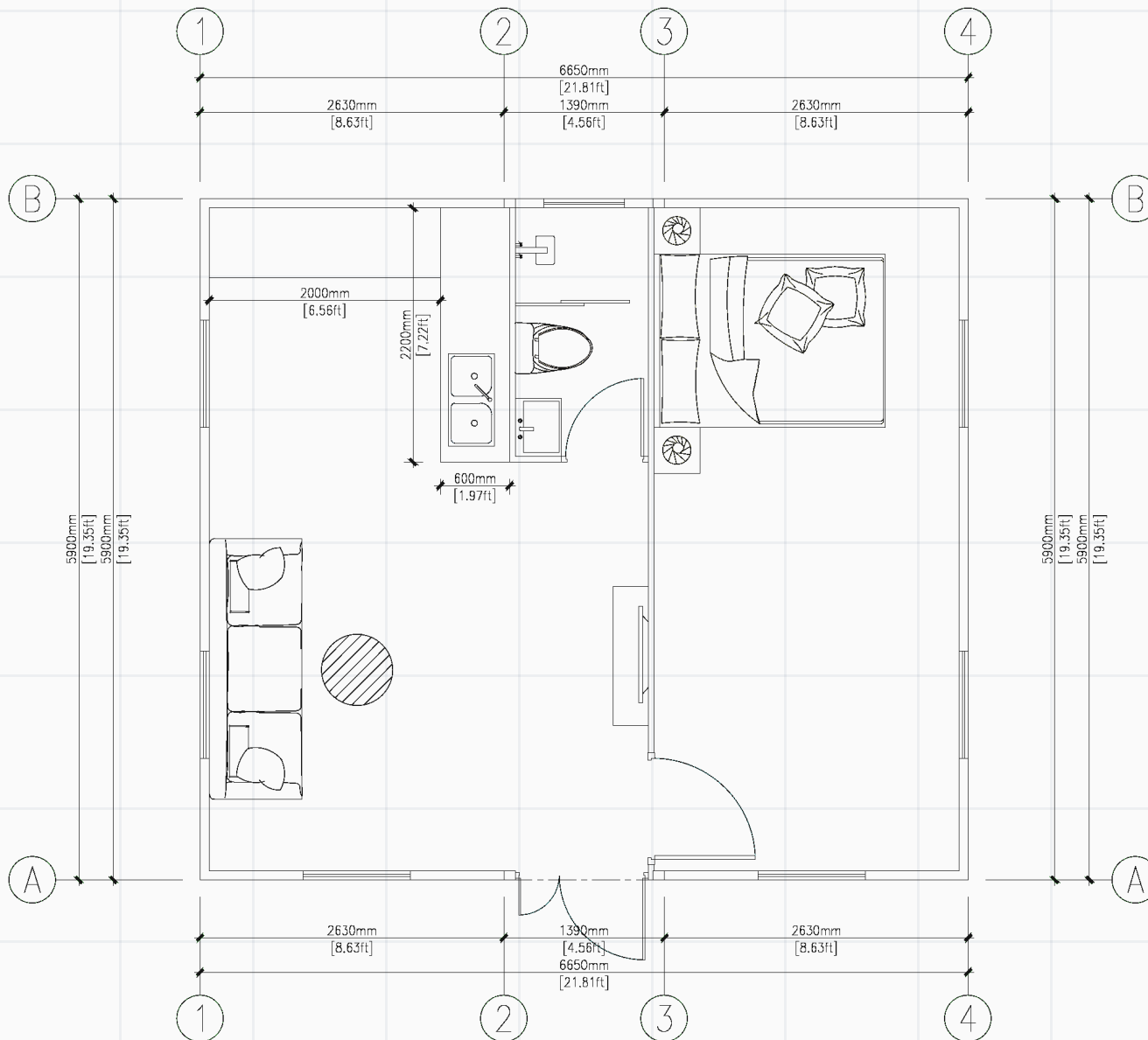

PLATE 04 · 1 BEDROOM · 2.4 M CEILING

Single bedroom open-plan studio.

Single bedroom layout – maximises open-plan living space. Ideal for couples, weekenders, or rental studios.

INCLUDED

- Queen master bedroom with corner windows
- Oversized open-plan kitchen + living zone
- Full bathroom – shower, toilet, vanity
- Full-height sliding doors to living zone

DIMENSIONS

5,900 mm	6,650 mm	39.2 m²
LENGTH	WIDTH	FLOOR AREA

1	2	2.4 m
BEDROOMS	SLEEPS	CEILING

FROM

\$40,400

AUD · incl. GST

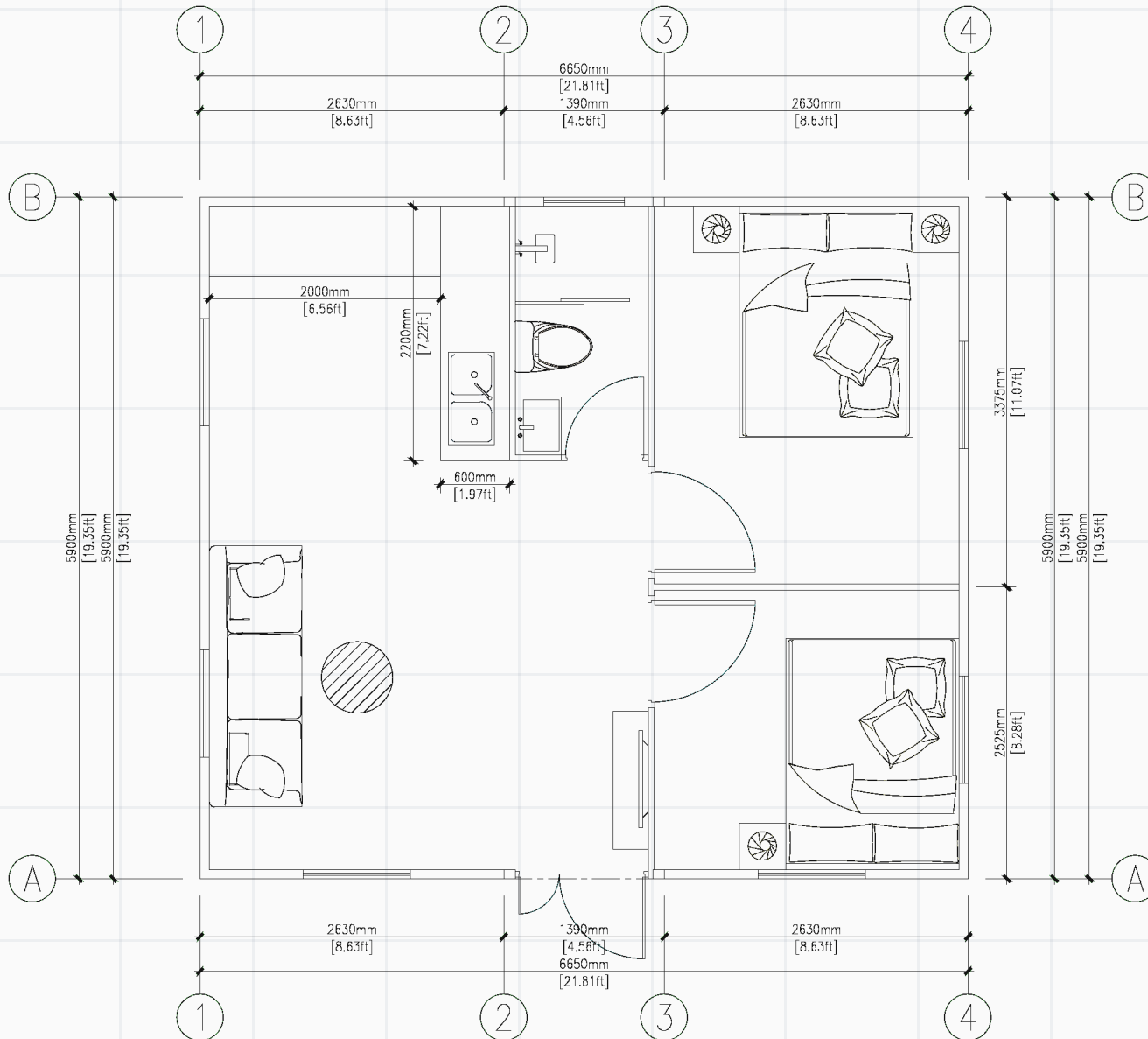

PLATE 05 · 2 BEDROOMS · 2.4M CEILING

Master + kids room / study.

Master plus a kids room / study with shared bathroom – great for small families, granny flats or short-stay setups.

INCLUDED

- Queen master with corner glazing
- Second room configured as kids room / study
- Shared central bathroom between both rooms
- Open-plan kitchen and living to the west

DIMENSIONS

5,900 mm **6,650 mm** **39.2 m²**
LENGTH WIDTH FLOOR AREA

2 **3** **2.4 m**
BEDROOMS SLEEPS CEILING

FROM

\$41,400

AUD · incl. GST

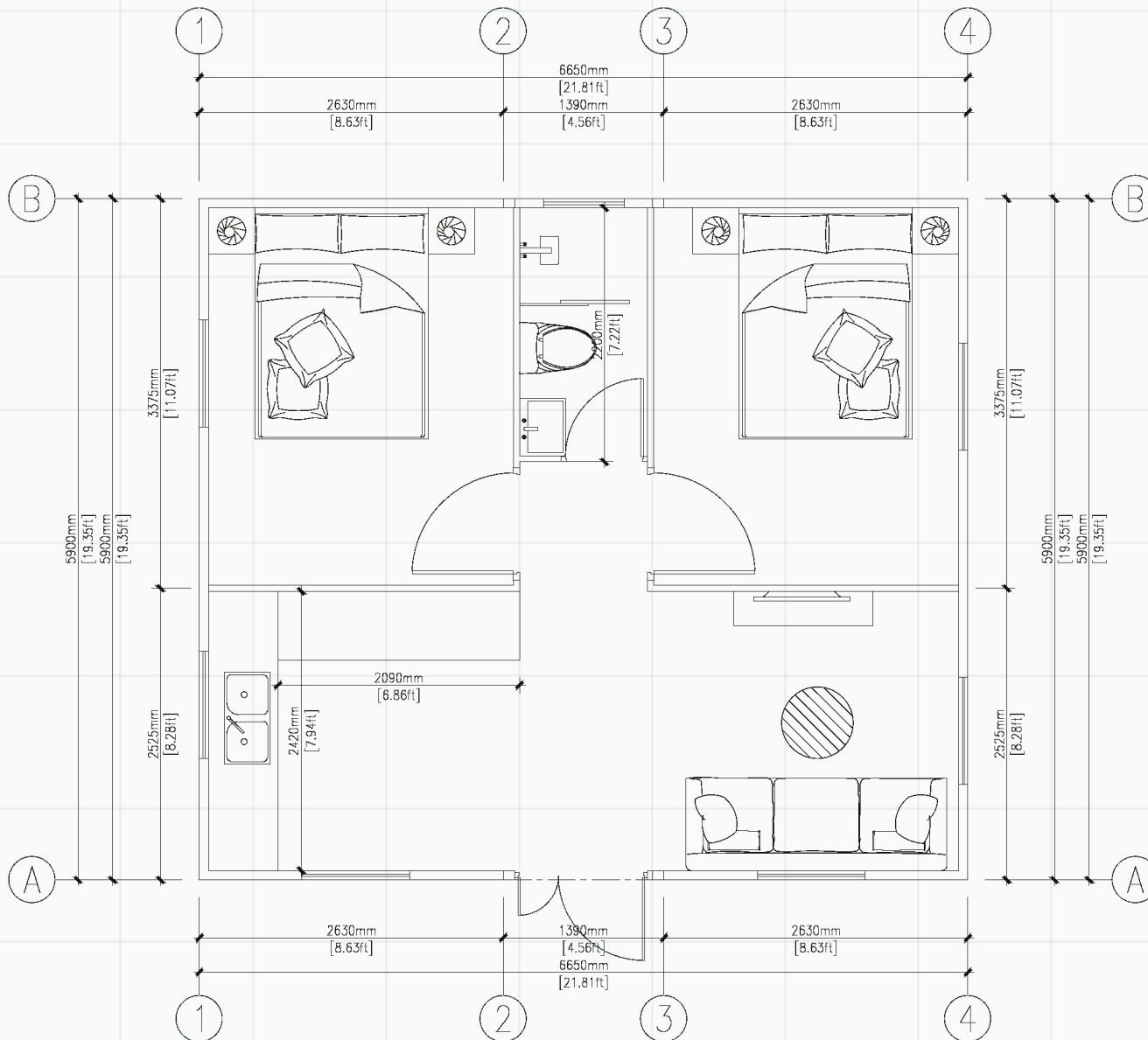

PLATE 06 · 2 BEDROOMS REAR · 2.4 M CEILING

2-bedroom rear layout.

Alternate two-bedroom configuration with both bedrooms positioned along the rear wall, central bathroom between, and an open-plan kitchen and living zone to the front.

INCLUDED

- Two queen bedrooms along the rear wall
- Central bathroom between bedrooms
- Open-plan kitchen along one side
- Living and lounge zone to the front
- Same 6,650 mm footprint as the standard 2-bedroom 2.4 m plate

DIMENSIONS

5,900 mm **6,650 mm** **39.2 m²**
LENGTH WIDTH FLOOR AREA

2 **3** **2.4 m**
BEDROOMS SLEEPS CEILING

FROM

\$41,400

AUD · incl. GST

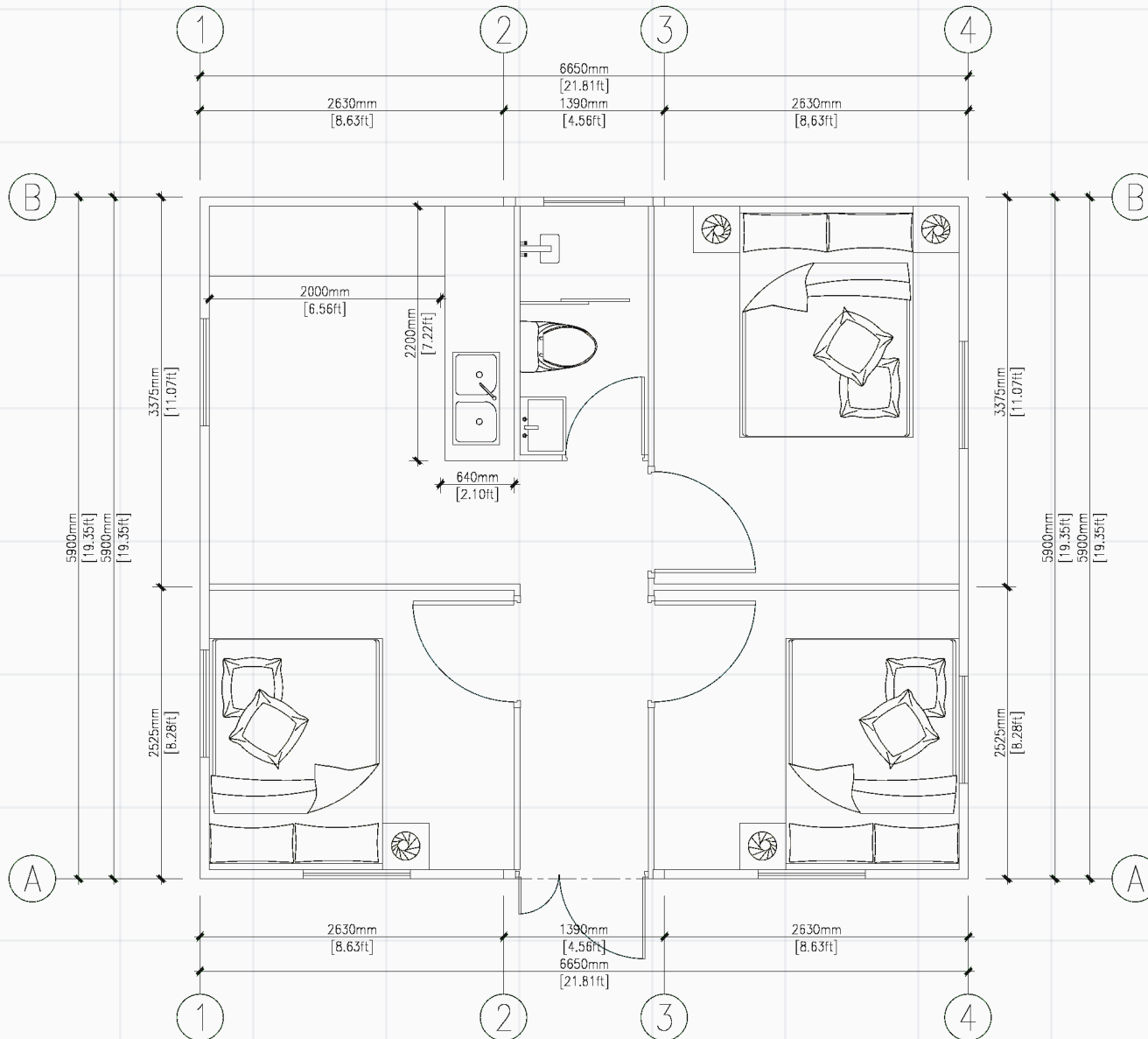

PLATE 07 · 3 BEDROOMS · 2.4 M CEILING

Three-bedroom family footprint.

Three bedrooms — a full family footprint in just 20ft. Flexible zones for kids, guests or a home office.

INCLUDED

- Queen master to the east wing
- Two kids rooms / studies off the central hall
- Compact kitchen + bathroom core
- Corridor entry with wardrobes to each bedroom

DIMENSIONS

5,900 mm **6,650 mm** **39.2 m²**
LENGTH WIDTH FLOOR AREA

3 **4** **2.4 m**
BEDROOMS SLEEPS CEILING

FROM

\$43,400

AUD · incl. GST